

Can I measure and draw straight lines accurately? (Y3)

Reasoning and problem solving

This page does not need to be printed. Write the short date you do the work and the above question in your book, underlining them neatly with a ruler.

1) Alex measures the line.

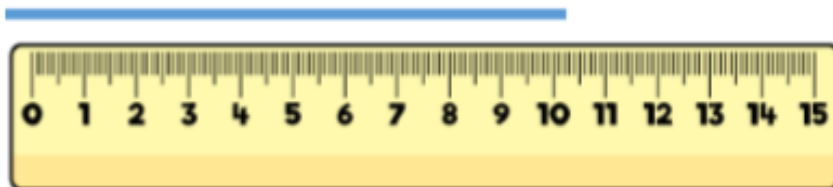

She says it is 10 cm 4 mm

Is Alex correct?

Explain why.

2)

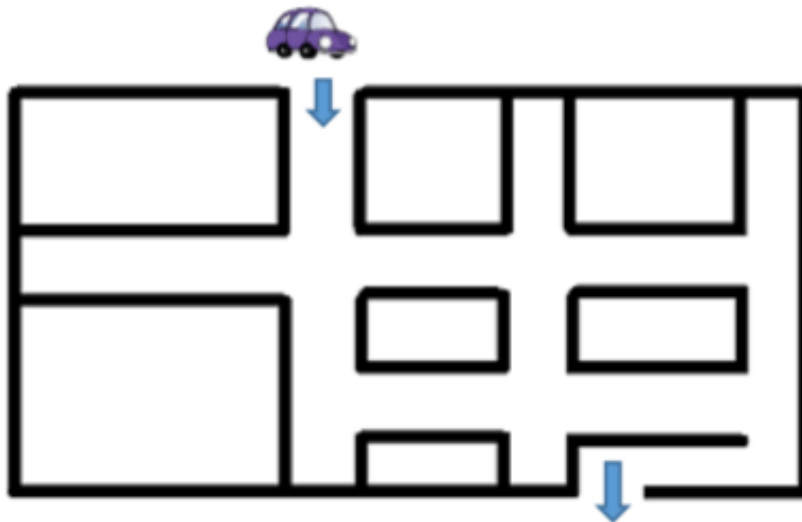

Use straight lines to show the route the car could take to get out of the maze.

Work out the length of the route to the nearest cm

Is this the shortest route?

Answers are on the next page.

Reasoning and Problem Solving

A horizontal ruler with a yellow background and black markings. The ruler is marked from 0 to 15 units. Major tick marks are labeled with black numbers from 0 to 15. Minor tick marks are present between the major numbers, representing half-unit increments. A blue line is drawn above the ruler, starting at the 0 mark and extending to the 10 mark.

Is Alex correct?
Explain why.

Alex is not correct because she has started measuring the line from the end of the ruler instead of from '0'

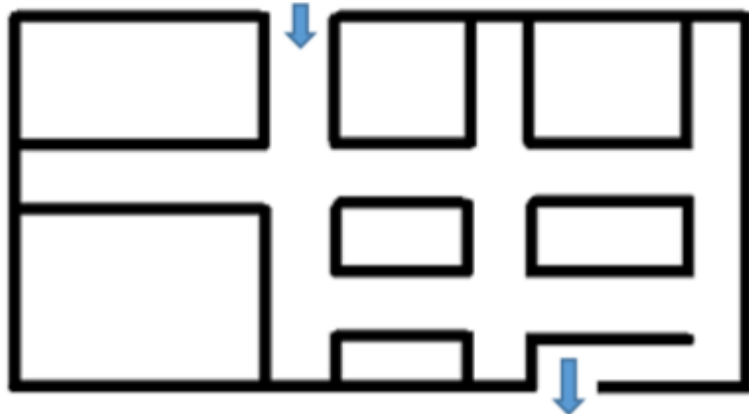

Is this the shortest route?

Possible answer:



The length of the route will depend on the size of the maze used.